

PAPER CRAFT



Assembly Instructions

Tools

Scissors, glue, ruler, tweezers, pencil



[Caution] Glue, scissors and other tools may be dangerous to young children so be sure to keep them out of the reach of young children.



Mountain fold (dotted line)
Make a mountain fold.



Valley fold (dashed and dotted line)
Make a valley fold.



Scissors line (solid line)
Cut along the line.



Cut in line (solid line)
Cut along the line.

Points to note when making the glider

1. Try to avoid bending the parts when you cut them out.

2.

Align the parts against a ruler to fold them.

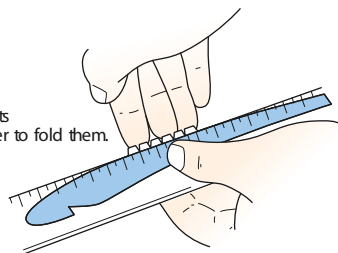

If any of the cut out parts are bent, this will seriously affect the glider's performance. Therefore, be sure to keep all parts perfectly flat till you join them up. For the wings, stabilizer and other parts, use a ruler to give you a proper straight edge to make your folds.

3. When assembling the parts, follow the assembly instructions and use the parts in the order given.

4. When sticking surfaces together, spread the glue evenly and stick the parts together quickly and line up the edges cleanly. While the glue is drying, put the fuselage inside a sheet of paper and then press it down with a book or similar in order to get a nice, straight finish.

5.

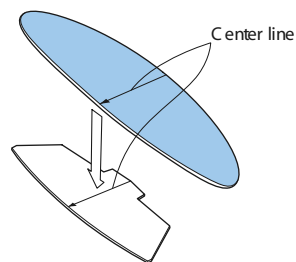

When sticking the right and left wings together, make sure that the center line is not off center.

6.

Rub with pencil or scissors to flatten out

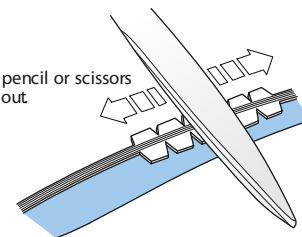

Flatten the uneven surface.

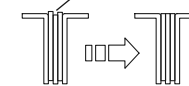

Cross section of the fuselage

To glue the wings flush onto the fuselage, use a pencil or scissors to flatten out the part where the wings attach to the fuselage.

7.

Dihedral angle

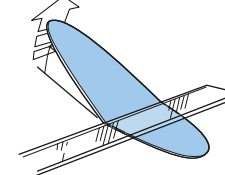

To give the wings an angle, bend along a straight ruler. (Refer to the assembly instructions for details on what degree of angle to use.)

8.

Make sure that the center line of the wings matches up exactly with the center line of the fuselage.

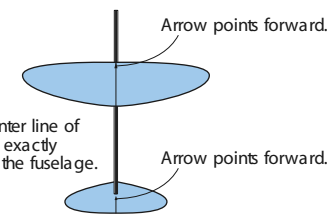

Also attach the horizontal stabilizer firmly.

Attach the wings and horizontal stabilizer carefully so that their center lines match up exactly with the center line of the fuselage.

GLUING INSTRUCTIONS

Glue the parts together in the order indicated.

3-1

Placing a ruler along the fold lines, bend the cut strips slightly upward.

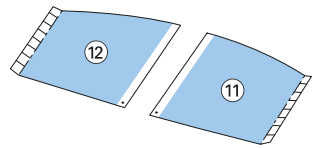

3-2

Glue parts 13 and 14 to the underside of parts 11 and 12 respectively.

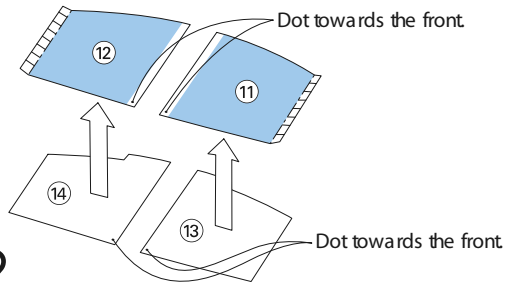

3-3

Using a ruler along the center line, fold part 15 from the center line to make 5° angle on both sides. Then curve it carefully with your fingers to fit the curved fuselage top where the main wings are to be attached.

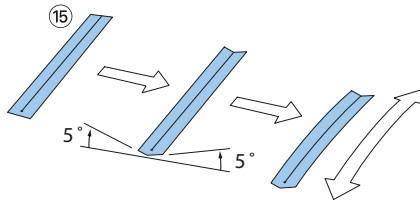

3-4

Curve the main wings, 11+13, 12+14 respectively in the same manner as 15. This curve is called camber.

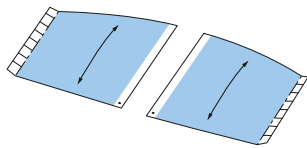

3-5

Apply glue on half of the underside of 15 and glue onto 12+14. (The dots on the parts should meet with each other.)

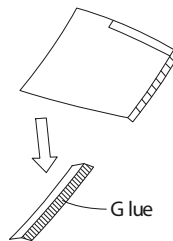

3-6

In the same manner, attach 11+13 to the other side of 15.

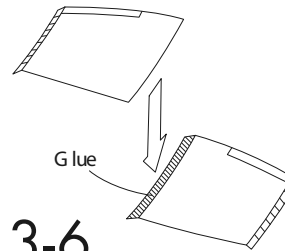

3.

Assemble the main wing following the assembly instructions 3-1 to 3-8.

Dot towards the front

2.

Aligning the noses flush, glue 1 through 10 together in the order shown.

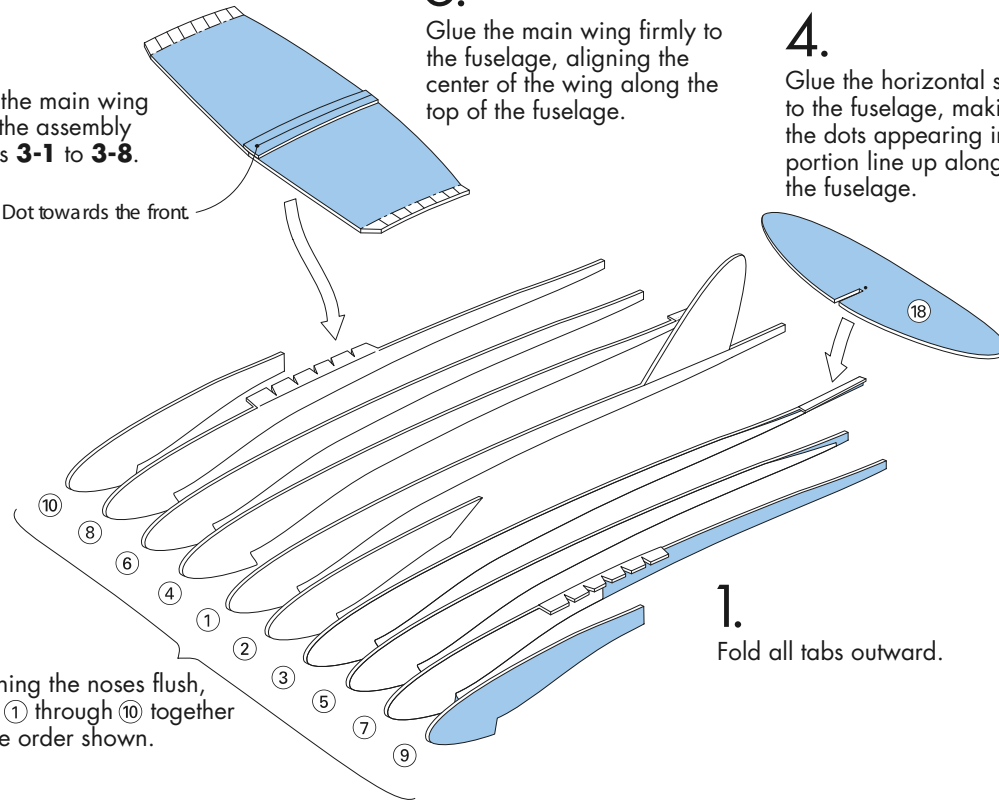

5.

Glue the main wing firmly to the fuselage, aligning the center of the wing along the top of the fuselage.

4.

Glue the horizontal stabilizer 18 to the fuselage, making sure that the dots appearing in its center portion line up along the top of the fuselage.

1.

Fold all tabs outward.

3-7

Placing the dihedral angle gauge on the main wing, check that the dihedral angle is 5°.

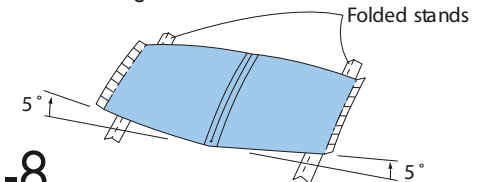

3-8

Putting folded stands under the main wing will be conducive to fast and thorough drying.

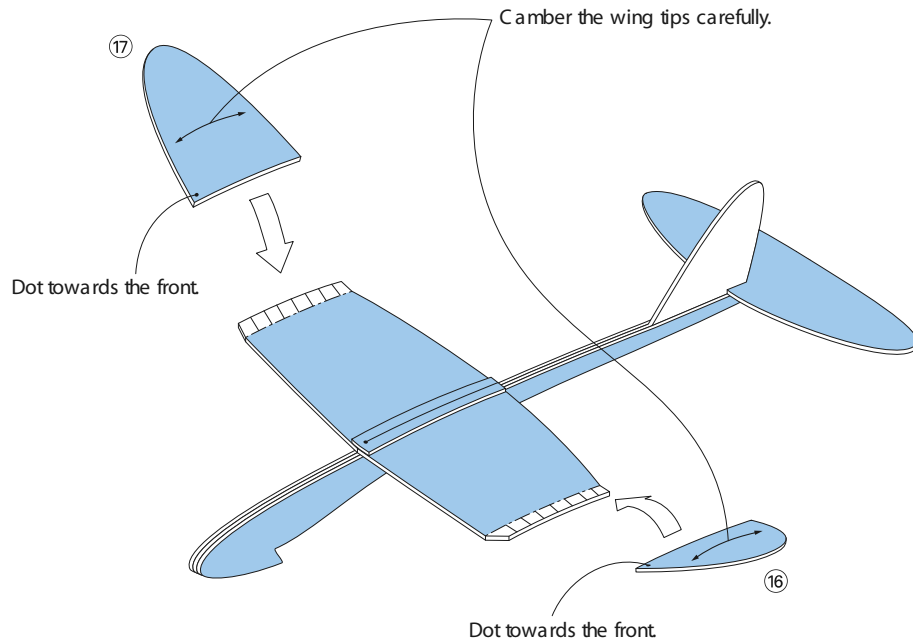

6.

Camber both wing tips ①⑥ and ①⑦ slightly. Fold tabs on both ends of the main wing to form a 30° dihedral angle using the gauge and then camber them as well.

7.

Apply glue to the top surface of the folded tabs of the main wing. Glue wing tips ①⑥ and ①⑦ onto them as shown. Once again, check that the dihedral angle at the tip of the wing is 30° using the gauge.

FINISHING TOUCHES

Give the finishing touches to the plane after it dries thoroughly.

8.

Level the camber on the main wings carefully with your fingers, checking the curve with the camber gauge.

9.

Using the dihedral angle gauge, make sure the dihedral angle for the main wing is 5° and for the wing tips is 30°.

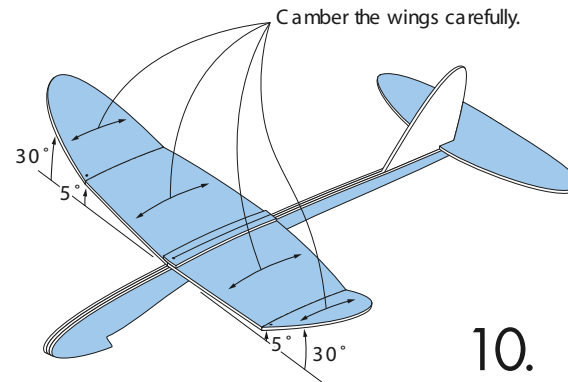

10.

View the plane from both the front and the back and straighten any warps or bends in the fuselage and the wings.