

Bipie

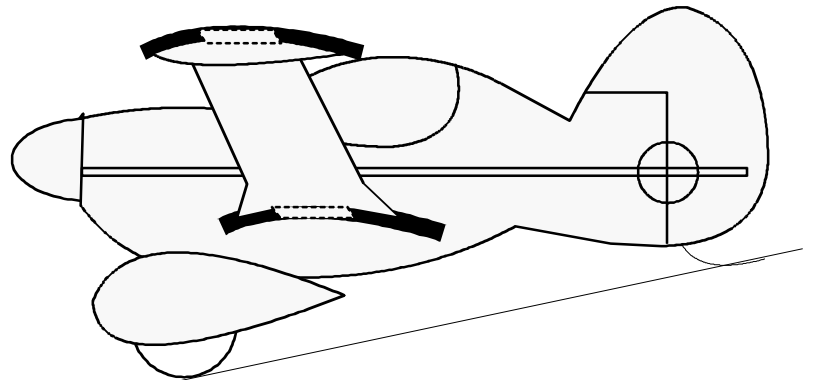

All parts made of 6mm DEPRON (or Blucor).
You will also need 2cm thick "Styrodur"
or Styrofoam and a few bamboo skewers.

Specs:

Length: 57cm

Wing Span: 63 cm

Design-Weight:
220 - 290g (depending on your equipment)

Wing loading: 13 g/dm²

Motor/Battery:
something capable of delivering
50Watt (light slow flyer) to
90Watt (HP aerobatics)
e.g. small BL outrunner with $I_{max}=7A$,
on 3s Lipo ($U=11V$), 1050 rpm/V,
9x4.7 GWS slowly prop
(=more than enough power)

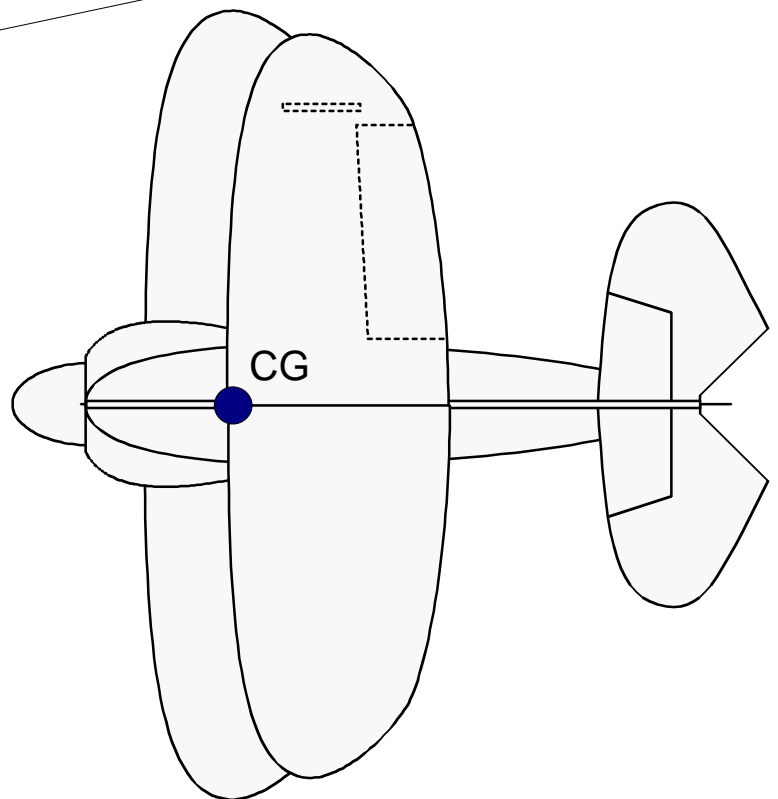

For more information, tips and detailed pictures please
refer to my build-thread at e-zone:

<http://www.rcgroups.com/forums/showthread.php?t=497522>

or PM me chara.k@gmx.de

Have Lots of fun !!!!
Chara

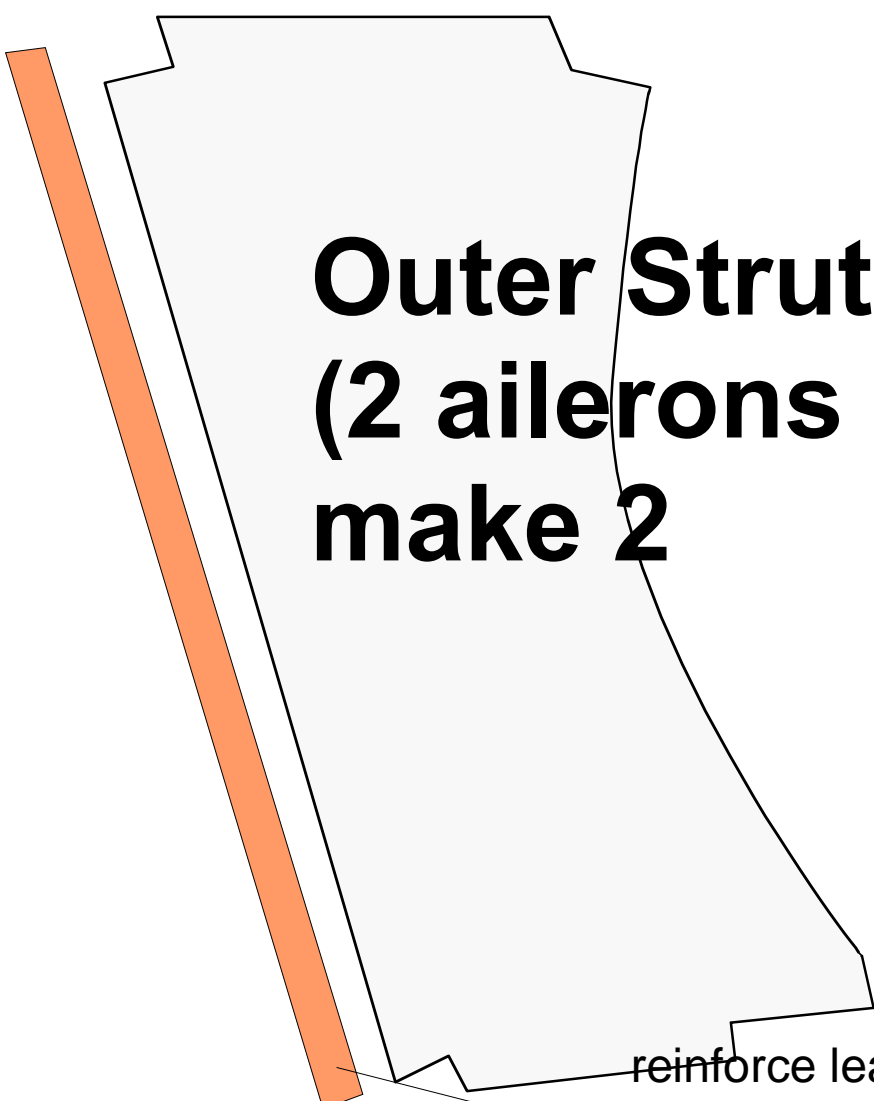
A diagram showing a light gray, irregularly shaped piece of material with a black outline. An orange rectangular strip is attached to the left side of the piece, extending from the top edge down to the bottom edge. The text 'Outer Strut (2 ailerons setup) make 2' is centered on the gray piece. A thin black line points from the bottom edge of the gray piece to the text 'reinforce leading edge with a bamboo skewer. glue and wrap around some cle'.

Outer Strut (2 ailerons setup) make 2

reinforce leading edge
with a bamboo skewer.
glue and wrap around some cle

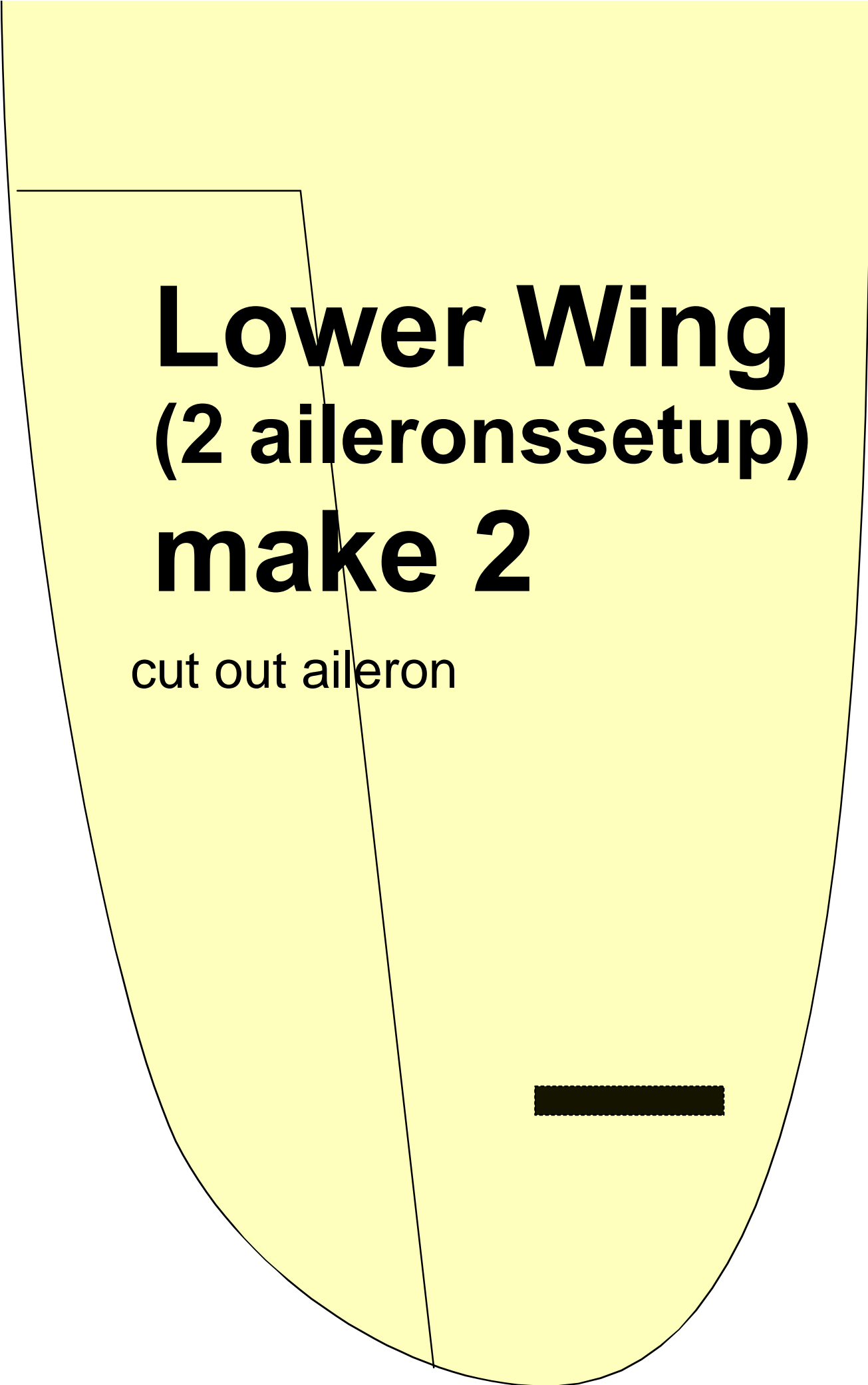

Lower Wing (2 ailerons setup) make 2

cut out aileron

position of wings
and inner struts

Nose is not needed :)

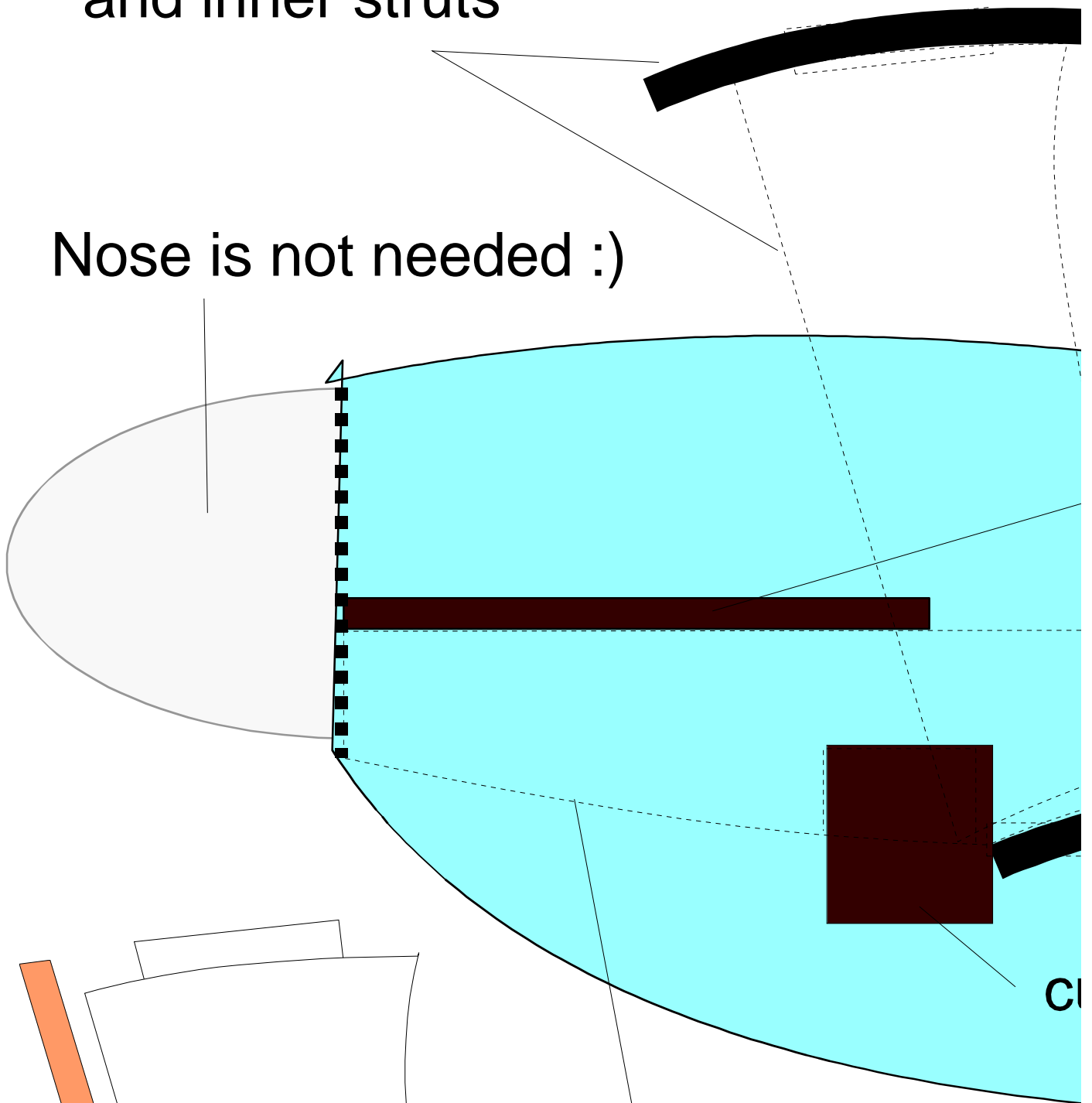

position of fuse reinf

inner strut
(make 2)

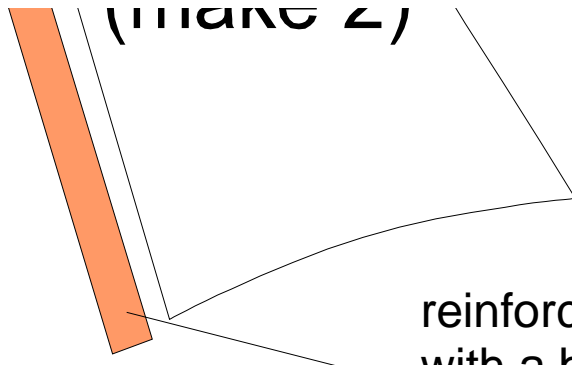

reinforce leading edge
with a bamboo skewer.
glue and wrap around some clear ta

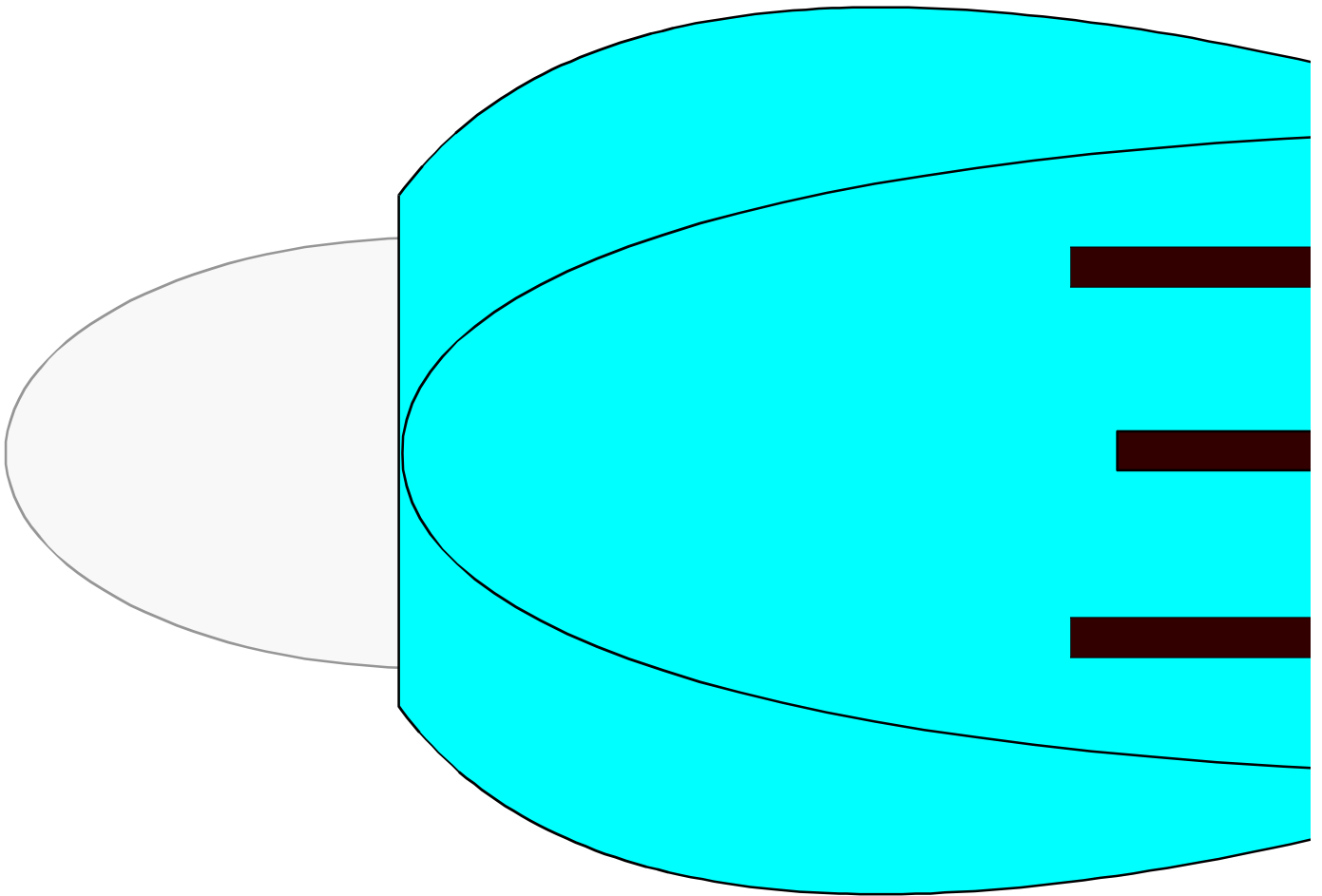

ear tape.

slots for inner struts -
exact position depends
on thickness of your
styrofoam parts!!!

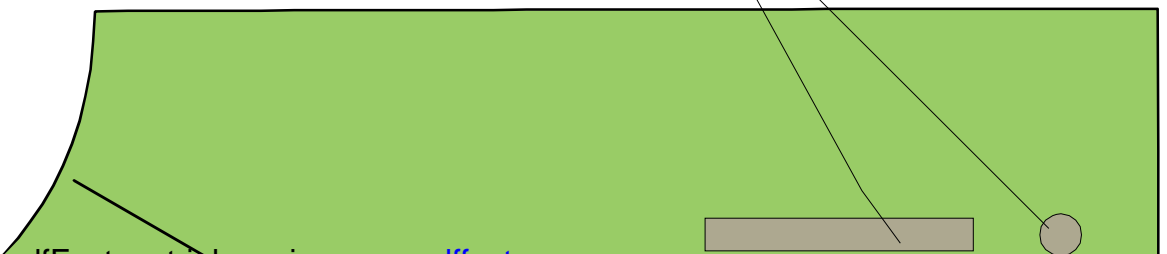



cut out aileron

Upper Wing make 2

cut out slot here

you may also use
cut a straight slot

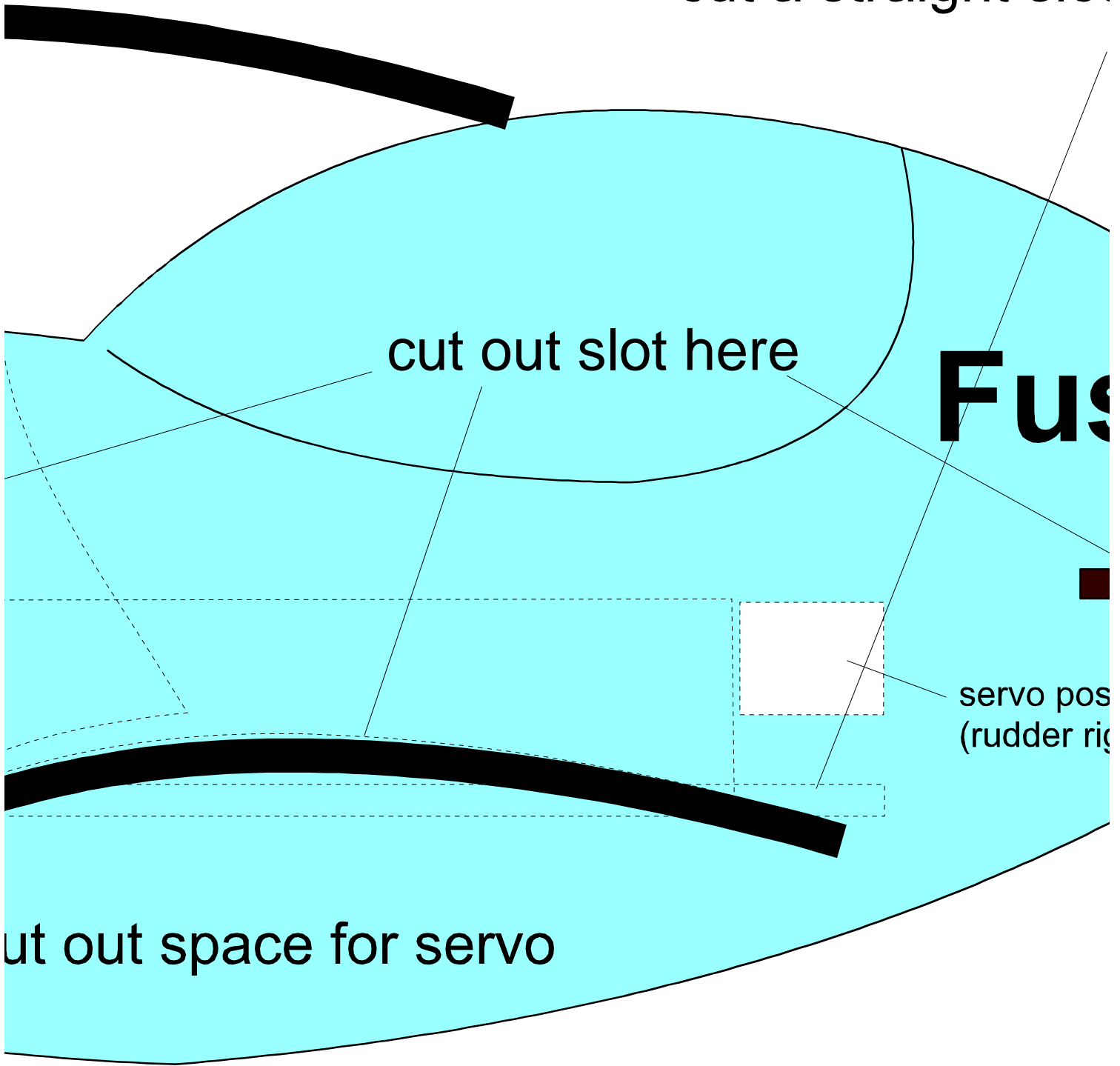

cut out space for servo

reinforcements

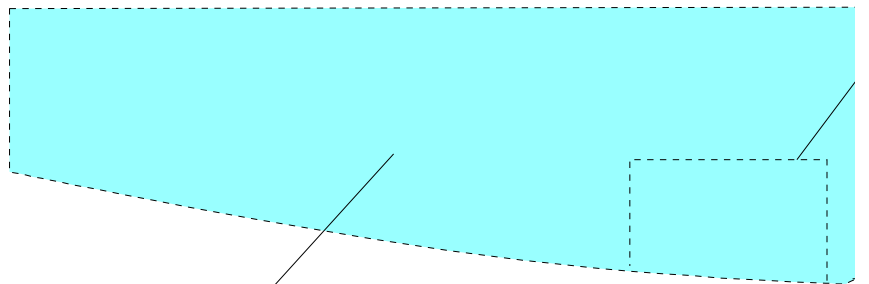

Fuselage Reinforcements (made of
that is very strong styrofoam -

like that, cut out 6x out of 6mm
2x3 pieces together.

ape.

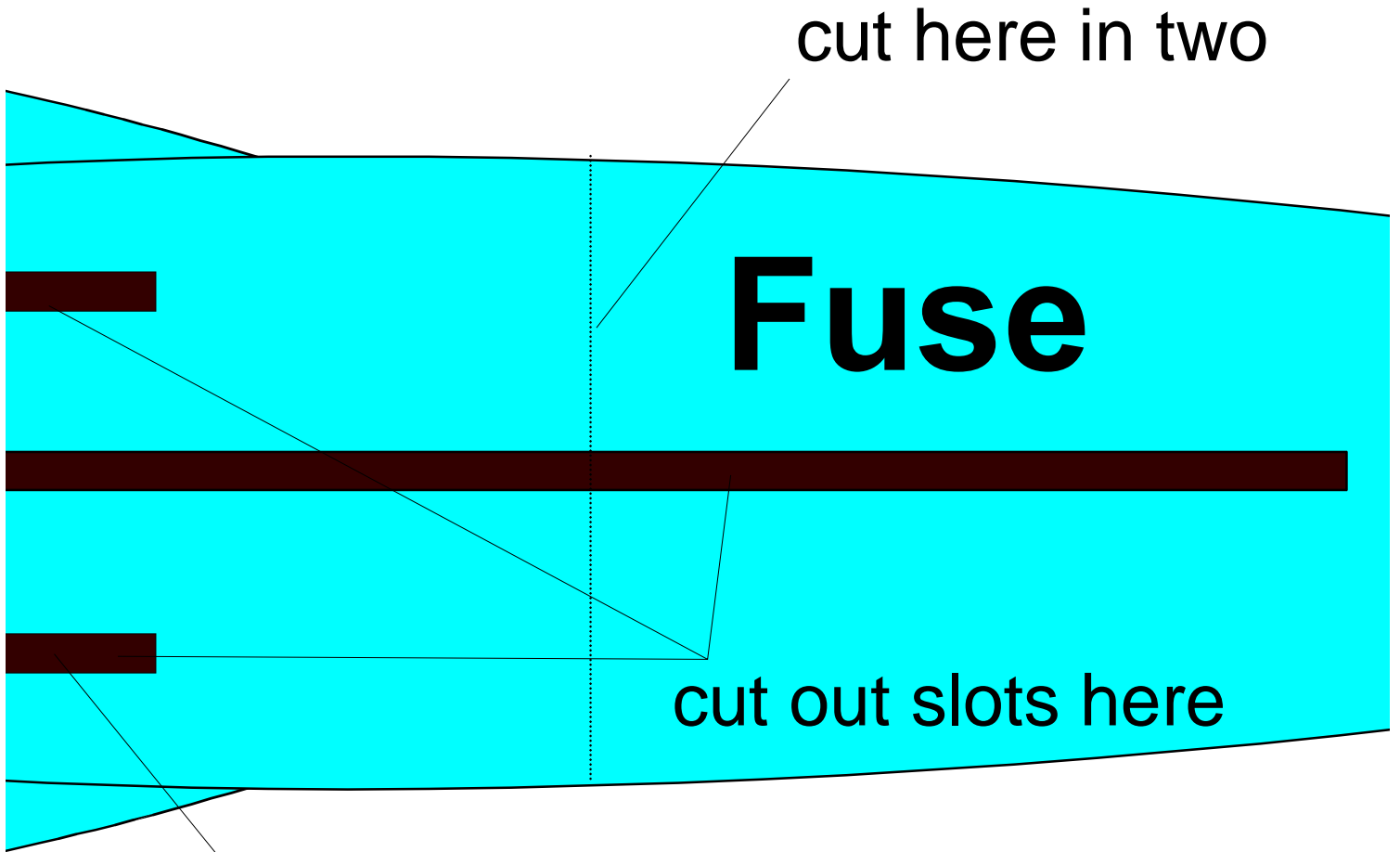

exact position of the slots for the
struts depend on the thickness of the
your fuse reinforcements!!!

roui

Lower Wing (4 ailerons setup) make 2

cut out aileron



the flat wing profiles.
that in that case

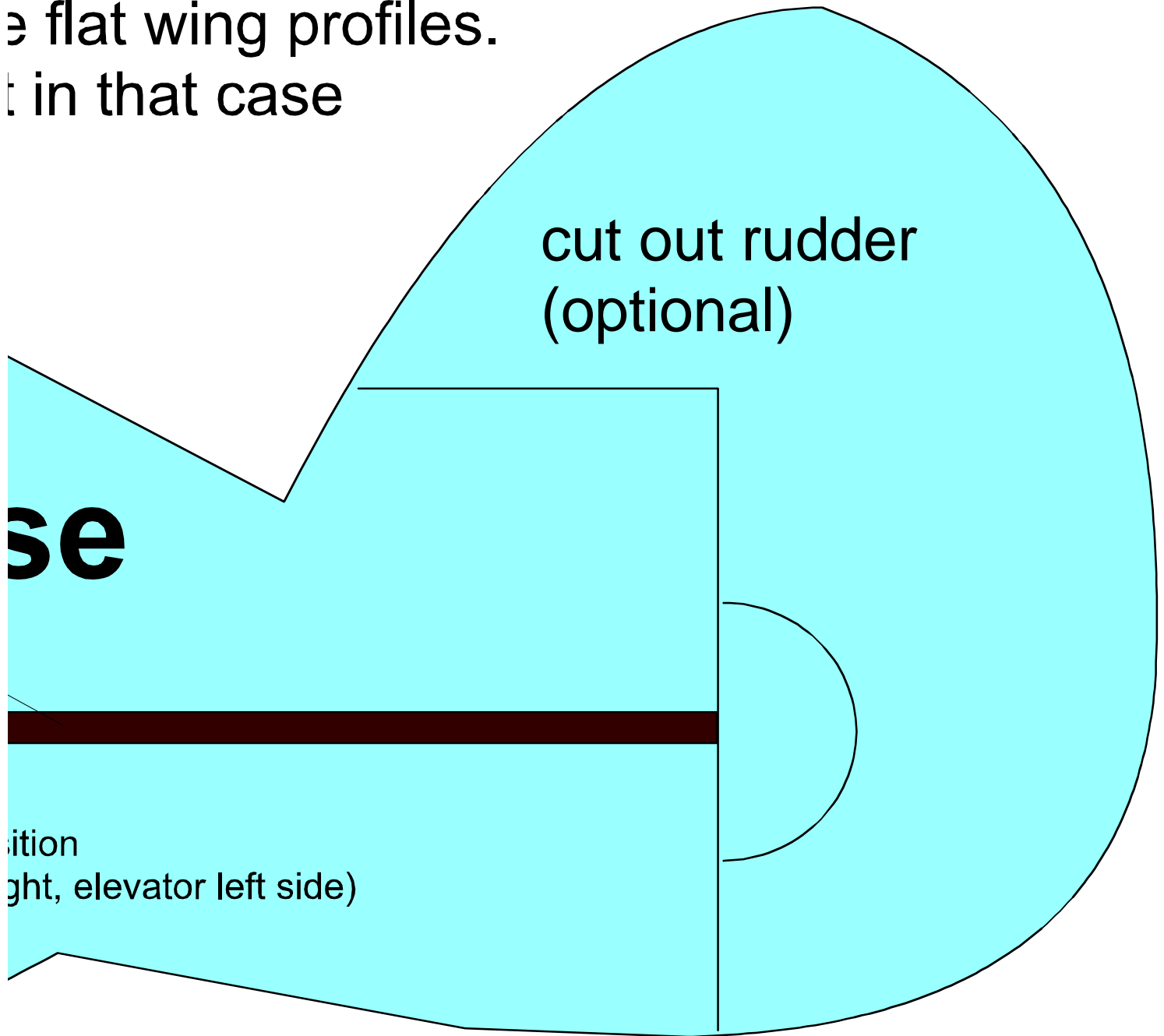

se

cut out rudder
(optional)

position
(right, elevator left side)

groove/cut out some space
for the aileron servo

straight bottom for
flat wing profile

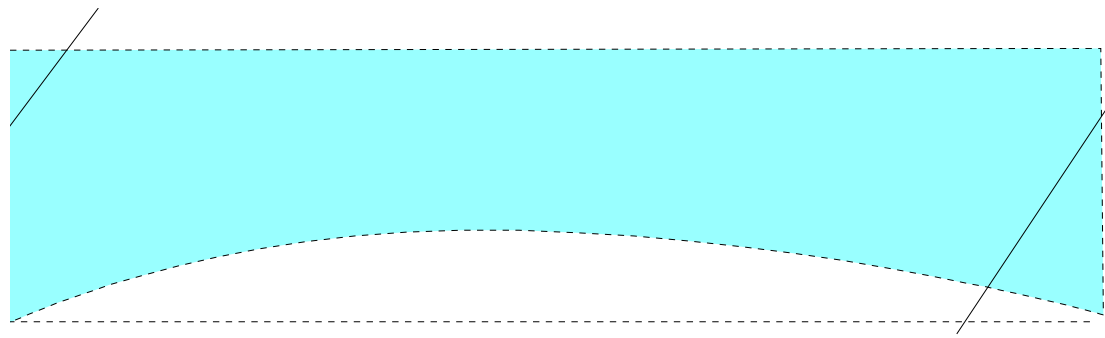

use a piece of 2cm thick "styrodur",
make 2). If you don't have something

n Depron/Blucor and laminate

cut out elevator

nd off a bit

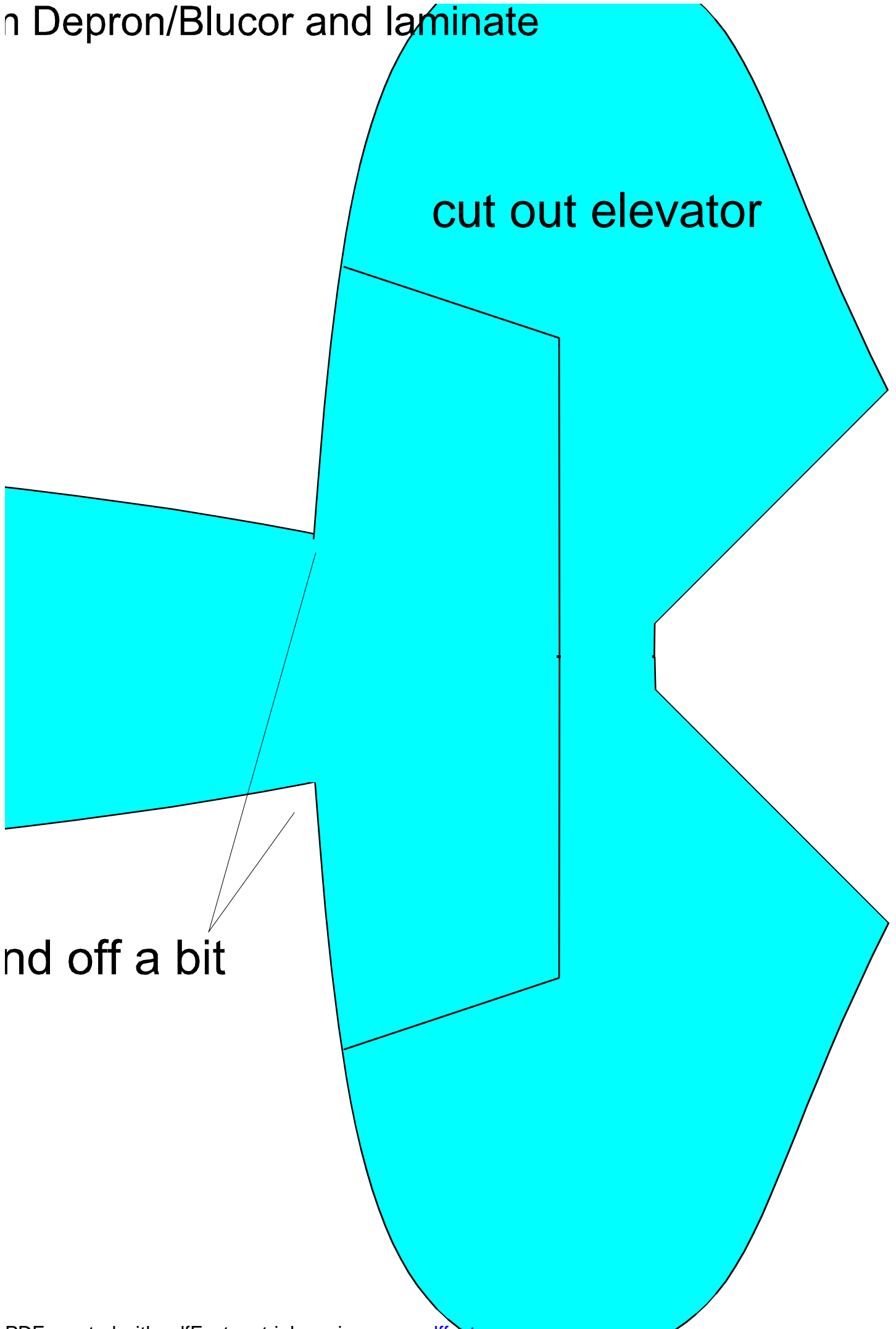

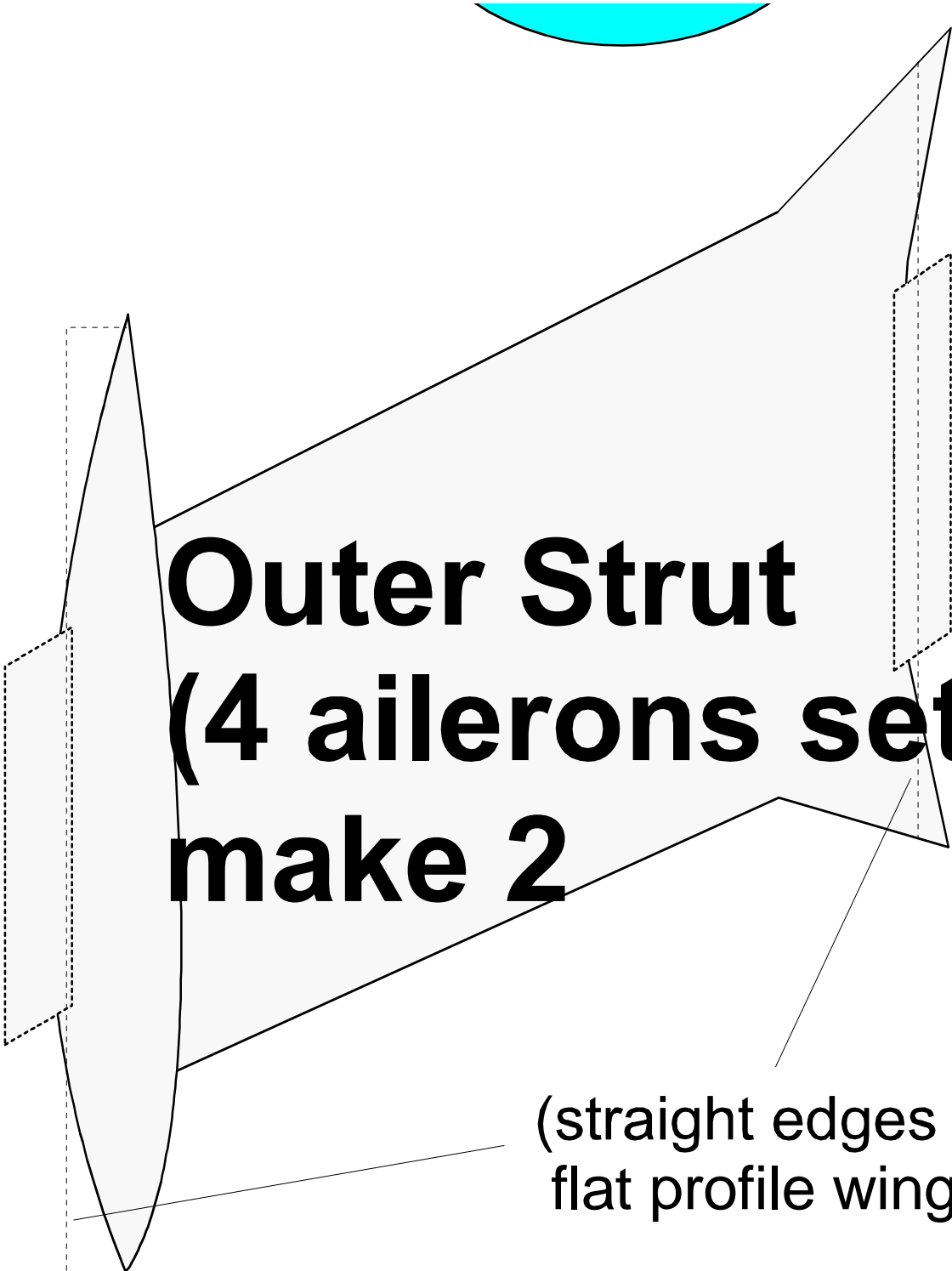

Outer Strut (4 ailerons setup make 2

(straight edges in cas
flat profile wing)



Shoe for optional LG